



Visit Us on the Web at www.chatillon.com

SLC Series Loadcells for DFS-R-ND Series

Specification Sheet
SS-FM-3015-0904
September 2004

The CHATILLON® SLC Series loadcells are full-bridge strain gauge sensors complete with 15-pin plug. These loadcells are used exclusively with the Chatillon DFS-R-ND Series digital indicator. The loadcell values and sensitivity factors are stored in memory within the sensor plug. When connected to a DFS-R-ND indicator, the capacity and calibration points are automatically recognized by the instrument. The instrument then becomes a full-featured load measurement instrument. The SLC Series loadcells meet ASTM E4 and BS EN ISO 7500 part 1 for a $\pm 0.25\%$ accuracy sensor. The loadcells are connected to the DFS-R-ND with a retractable cord that extends fully to nearly 9 ft. (3 m).

DFS-R with Low Capacity Sensor



Remote Sensors- Load Measurement

	Model	ozf	gf	lbf	kgf	N
Low	SLC-250G	9 x 0.002	250 x 0.05	0.55 x 0.0001	-	2.5 x 0.0005
	SLC-0002	35 x 0.01	1000 x 0.2	2.2 x 0.0005	1 x 0.0002	10 x 0.002
	SLC-0010	180 x 0.05	5000 x 1	11 x 0.002	5 x 0.001	50 x 0.01
	SLC-0025	350 x 0.1	10000 x 2	22 x 0.005	10 x 0.002	100 x 0.02
High	SLC-0050	900 x 0.2	25000 x 5	55 x 0.01	25 x 0.005	250 x 0.05
	SLC-0100	1800 x 5	50000 x 10	110 x 0.02	50 x 0.01	500 x 0.1
	SLC-0200	3500 x 1	-	220 x 0.05	100 x 0.02	1000 x 0.2
	SLC-0500	-	-	560 x 0.1	250 x 0.05	2500 x 0.5
	SLC-1000	-	-	1100 x 0.2	500 x 0.1	5000 x 1

Specifications

- Input Resistance:** 1000 ohms ± 100
- Output Resistance:** 1000 ohms ± 100
- Rated Output:** 2.0 mV/V
- Safe Overload:** 150% Full Scale
- Non-Linearity:** $\pm 0.05\%$ Full Scale
- Hysteresis:** $\pm 0.05\%$ Full Scale
- Zero Balance:** $\pm 1.0\%$ Full Scale
- Operating Temp:** 30° to 120°F (-40° to 82°C)

Medical Devices



Pharmaceuticals



Springs & Components

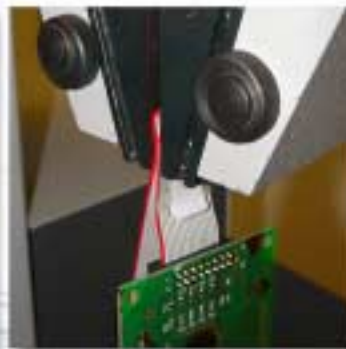

General Purpose Force



Dimensions

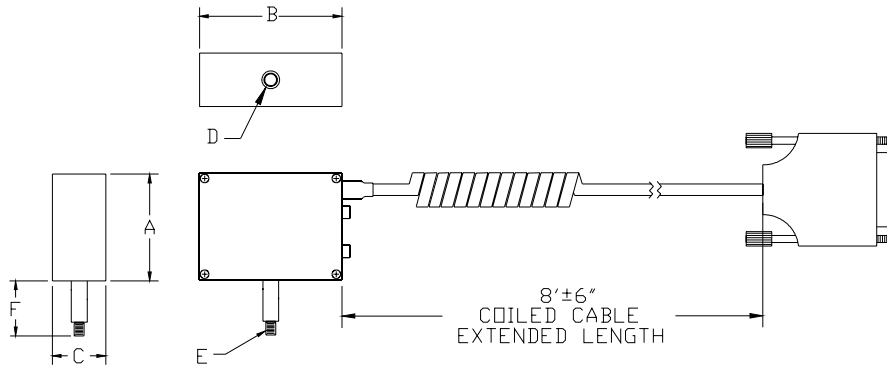

25 LBF	1.50 [38.1]	2.00 [50.8]	.75 [19.0]	#10-32	#10-32	.75
10 LBF	1.50 [38.1]	2.00 [50.8]	.75 [19.0]	#10-32	#10-32	.75
2 LBF	1.50 [38.1]	2.00 [50.8]	.75 [19.0]	#10-32	#10-32	.75
250 G	1.50 [38.1]	2.00 [50.8]	.75 [19.0]	#10-32	#10-32	.75
CAPACITY	A	B	C	D FEMALE THREAD	E MALE THREAD	F

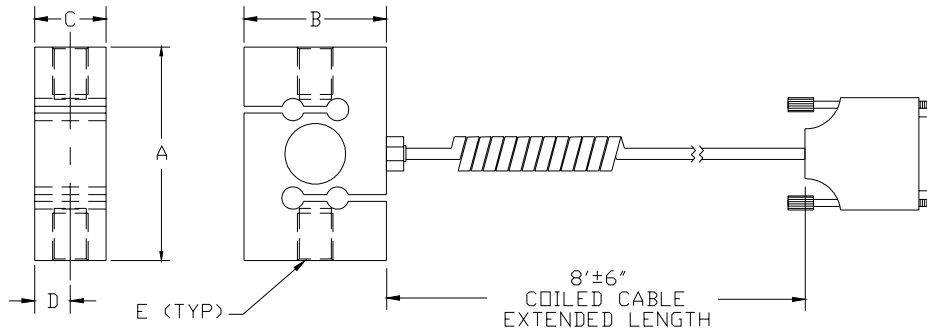

1000 LBF	2.98 [75.7]	2.50 [63.5]	.98 [24.9]	.49 [12.4]	1/2-20
500 LBF	2.98 [75.7]	2.00 [50.8]	.98 [24.9]	.49 [12.4]	1/2-20
200 LBF	2.48 [63.0]	2.00 [50.8]	.61 [15.5]	.31 [7.9]	1/4-28
100 LBF	2.48 [63.0]	2.00 [50.8]	.61 [15.5]	.31 [7.9]	1/4-28
50 LBF	2.48 [63.0]	2.00 [50.8]	.61 [15.5]	.31 [7.9]	1/4-28
CAP.	A	B	C	D	E THREAD

E96-355

AMETEK TEST AND CALIBRATION INSTRUMENTS

For the authorized Chatillon Distributor or Manufacturer's Representative near you, go to www.chatillon.com

Americas
AMETEK TCI Division
8600 Somerset Drive
Largo, Florida 33773
United States of America
Tel +1-727-536-7831
Tel +1-800-527-9999
Fax +1-727-539-6882
Email chatillon.fl-lar@ametek.com

France
AMETEK Lloyd Instruments SAS
3 avenue des Coudriers
Zone d'Activite de l'Observatoire
78180 Montigny-Le-Bretonneux
France
Tel +33-1-3057-4774
Fax +33-1-3057-5033
Email general@lloyd-instruments.com

Germany
AMETEK Precision Instruments
Europe GmbH
Rudolf-Diesel-Strasse 16
D-40670 Meerbusch
Germany
Tel +49-0-2159-9136-70
Fax +49-0-2159-9136-80
Email apie@ametek.dr

Singapore
AMETEK Singapore Pvt. Ltd.
10 Ang Mo Kio Street 65
#05-12 Techpoint
Singapore 569059
Tel +65-484-2388
Fax +65-481-6588
Email aspl@ametek.com.sg

United Kingdom
AMETEK Lloyd Instruments Ltd.
Forum House, 12 Barnes Wallis Rd
Segensworth East
Fareham
Hampshire PO15 5TT
United Kingdom
Tel +44-0-1489-574221
Fax +44-0-1489-885118
Email general@lloyd-instruments.co.uk

Visit Us on the Worldwide Web at:
www.chatillon.com

© 2004 by AMETEK, Inc.
Information within this document is subject to change without notice.



ISO 9001:2000
ISO/IEC 17025
Manufacturer